



# Mahagiri

## GOLDEN HILLS



ಭಾವು ಪರಿಗಿಸು  
- ಜನಾಭ ಪರಿಗುಕುಂದಿ

@ Munganoor, Hayath Nagar

GATED COMMUNITY VILLA PROJECT



**hmda**  
Growing Global  
**APPROVED LAYOUT**



**100%**  
ಕ್ರಿಯಾತ್ಮಕ ಲಾಭ  
ನಿರೀಕ್ಷಿಸಿ



Experience The Best That life Can Give You...



A Prestigious Project From  
**SIRI LAXMI SAI**  
CONSTRUCTION PRIVATE LIMITED



**LOCATION MAP**  
( Not to Scale )



**SIRI LAXMI SAI**  
CONSTRUCTION PRIVATE LIMITED

# 3-11-127, Road No.1 RTC Colony, Opp, Kamineni Hospital

CONTACT :

9000183488

# EAST FACING - GROUND FLOOR

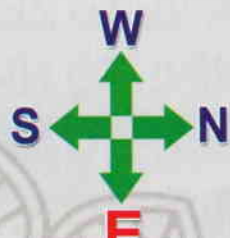
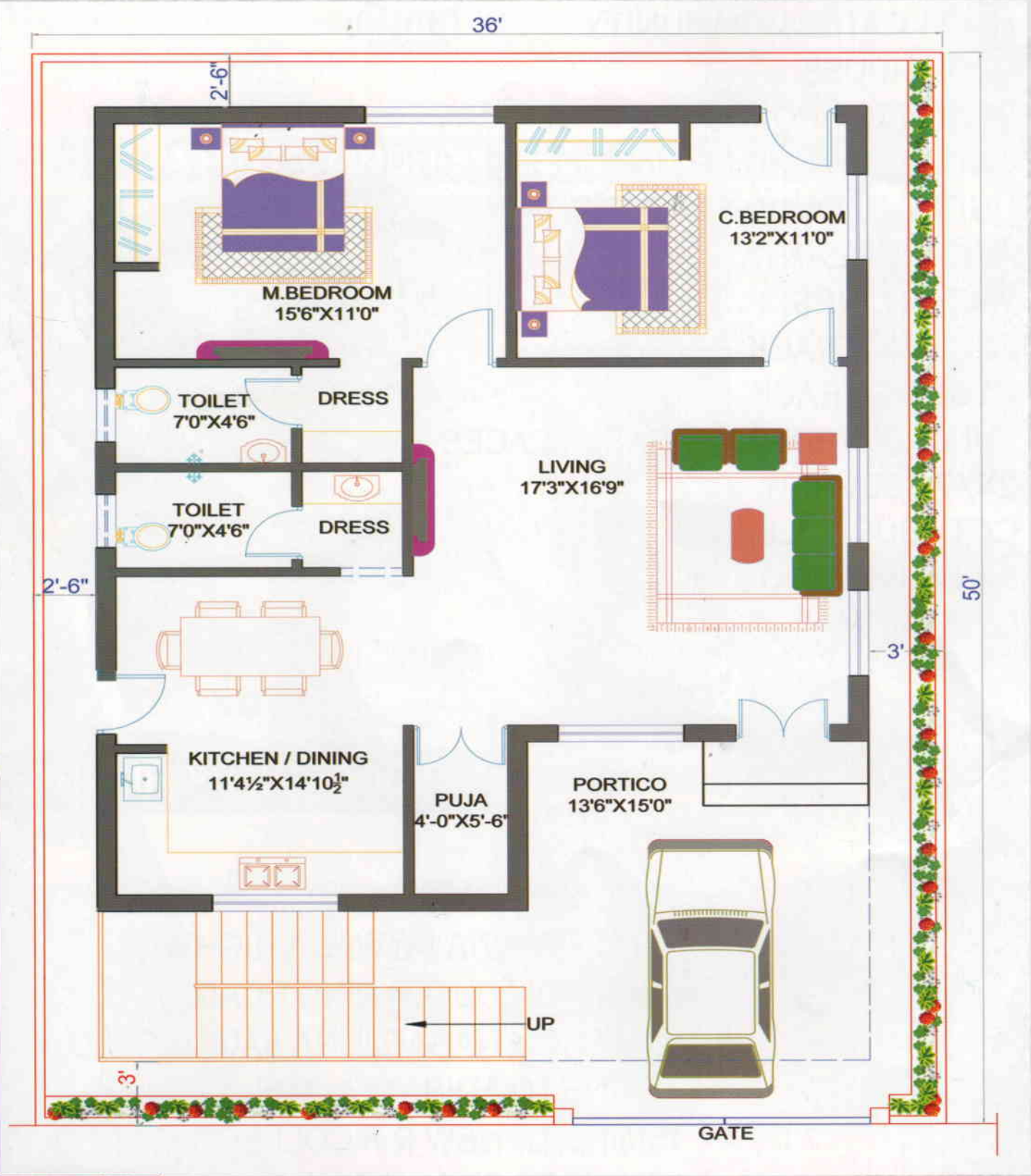



# EAST FACING - FIRST FLOOR

36'

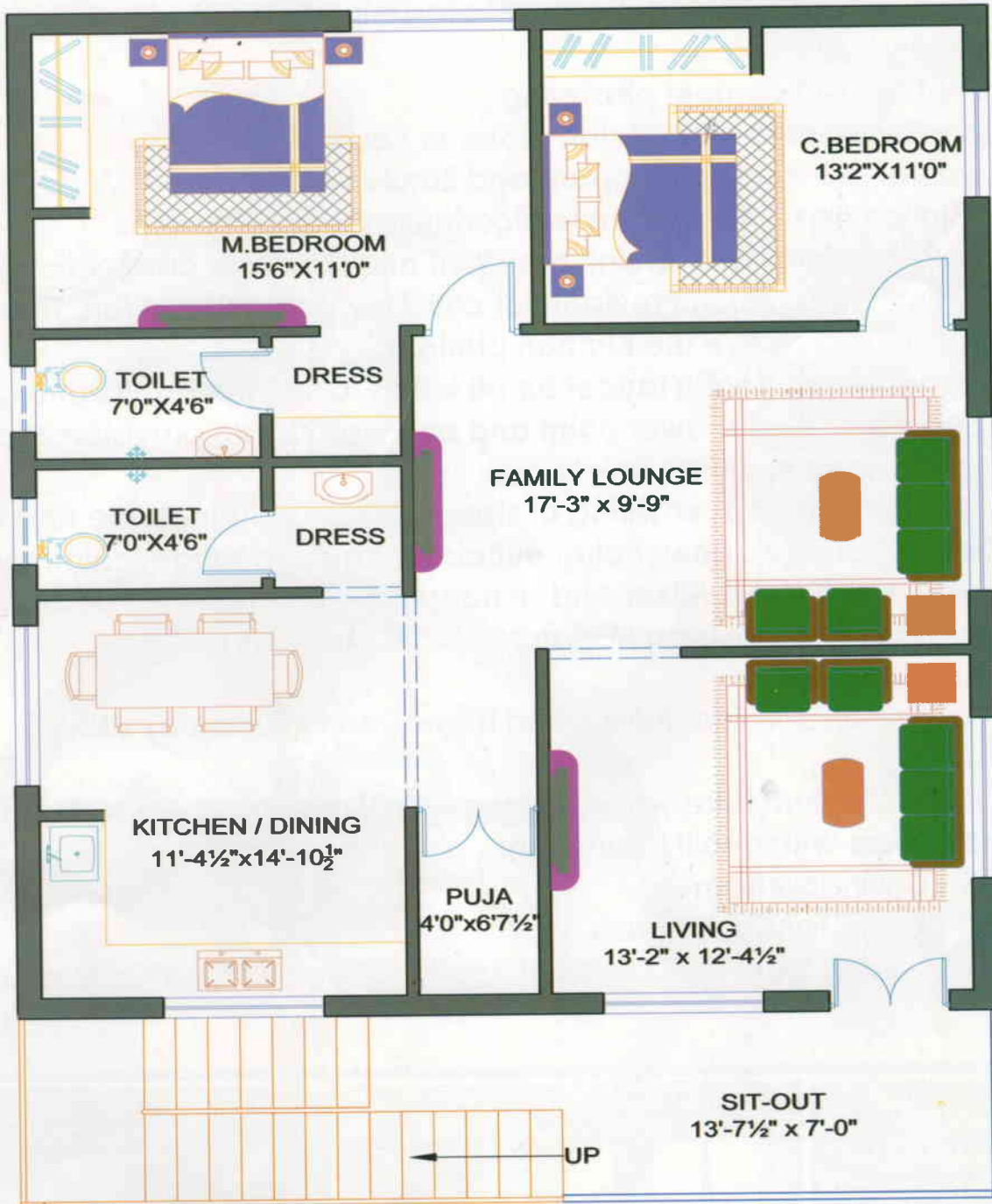

## SPECIFICATIONS:

- \* **STRUCTURE** : RCC Framed Structure, Footings, Columns, Beams, and Slabs with RCC designed Grade Concrete as per Structural Consultant
  - \* **SUPER STRUCTURE**: First class light weight red brick work.
  - \* **PLASTERING INTERNAL**: Double coat cement plastering finished with Lappam and Putty
  - \* **EXTERNAL** : Double coat cement plastering
  - \* **PAINTING** : Exterior paint of ACE , Asian make or Equivalent
  - \* **INTERNAL** : Internal two coats of Lappam and Emulsion paints
  - \* **FLOORING** : Vitrified tiles 800\*800 mm for floorings . Granite for steps
  - \* **KITCHEN**: Granite platform with SS sink provision and separate connections for borewell and Municipal Water. Provision for chimney and exhaust fan. Tiles dadoing upto 2' height above the Kitchen platform.
  - \* **TOILETS** : Wash basin and health faucet for all toilets. One indian W/C and another one an European W/C And shower point and one wash basin provision in any toilet and soap box provision in all The toilets
  - \* **ELECTRICAL** : Consealed copper wiring of standard make , Telephone and TV points modular switches (Anchor), power plug outlets for cooking range, chimney, refrigerator microwave oven, Mixer and grinder in the kitchen area and cable TV and internet connection provision Miniature circuit breakers (MCB) for each distribution.
  - \* **JOINERY WORK**: Indian medium take wood frames and shutters by using quality Hardware.
  - \* **INTERNAL DOORS**: Medium take wood frames with 35mm thickness water proof solid core flush doors With quality hardware.
  - \* **WINDOWS** : UPVC window frames
  - \* **PARKING**: Best quality Tandoor Stones
- STEEL & CEMENT** : Jairaj Steel or equivalent and Ultra Tech cement or its equivalent





## PROJECT HIGHLIGHTS

- ▶ HMDA GATED COMMUNITY
- ▶ CLUB HOUSE
- ▶ BLACK TOP ROADS
- ▶ UNDER GROUND DRAINAGE
- ▶ UNDER GROUND ELECTRICITY
- ▶ AVENUE PLANTATION
- ▶ WATER LINES
- ▶ JOGGING TRACK
- ▶ CYCLING TRACK
- ▶ FULLY DEVEDLOPED PARK SPACES
- ▶ 24/7 SECURITY
- ▶ CCTV SURVAILLANCE
- ▶ SWIMMING POOL
- ▶ GYM ROOM



## LOCATION HIGHLIGHTS

- ❖ 80FT APPROACH ROAD
- ❖ 3KM FROM VIAJAYWADA HIGHWAY
- ❖ 4KM FROM OUTER RING ROAD
- ❖ 5KM FROM NAGARJUNA SAGAR ROAD
- ❖ 15MINS TO ADIBATLA, TCS
- ❖ 15MINS TO NEW R.R COLLECTORATE OFFICE
- ❖ 15MINS TO ZEE INTERNATIONAL SCHOOL
- ❖ 45MINS TO HI-TECH CITY
- ❖ 30MINS TO NEELAKANTA VIDYAPEETH
- ❖ 20MINS TO RAMOJI FILM CITY